

# Sentinel® XL

## Fume Hood Monitor



SXL-EFA

### Introduction

The Escalator Sentinel® XL Fume Hood Monitor is designed to enhance hood safety by monitoring face velocity in real time. The system will generate an alarm if the face velocity drops lower than the low alarm set point or rises higher than the high alarm set point.

### Key Features:

- Specifically designed for Escalator fume hoods.
- Easy to install.
- Simple to calibrate.
- Real time monitor of face velocity.
- Hassle-free self-test procedure.
- Audible (mutable) and visual alarm.
- Field adjustable face velocity alarm set point, to meet local regulatory and application requirements.
- Display units selectable between US (imperial) and metric.
- User-configurable PIN to restrict unauthorized configuration.
- Temperature compensated airflow sensor.
- Facilitates hood compliance with industry standards:
  - OSHA
  - NFPA
  - ANSI Z9.5
  - EN 14175
- Compatible with EFA, EFP, EFQ, EFI and EFF hoods.

### General Specifications, Sentinel XL

Model	SXL-EFA	
Control Panel Dimensions (W x H)	112 mm (4.4") x 80 mm (3.1")	
Audible Alarm	85 dBA	
Low Alarm Point	Default: 0.3 m/s (59 fpm) - adjustable	
High Alarm Point	Default: 0.7 m/s (138 fpm) - adjustable	
Electrical	100 - 240 VAC, 50/60 Hz	SXL-EFA
	Power Consumption	2.7 W / Single Phase
Indicator LEDs	SAFE (Green), UNSAFE (Red), MUTE (Yellow)	
Night Setback Relay Input	SPST NO (normally open), 3.3 VDC Close relay to mute alarm (current: 3.3 mA)	
Weight	2.5 kg (5.5 lbs)	
Shipping Dimensions (W x D x H)	271 x 303 x 101 mm (10.7"x 12.0"x 4.0")	



## Airflow Sensor (Mounts at Fume Hood Side Wall)

Front View

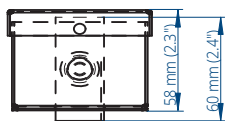

Top View

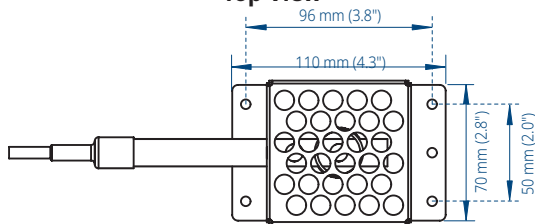

Side View

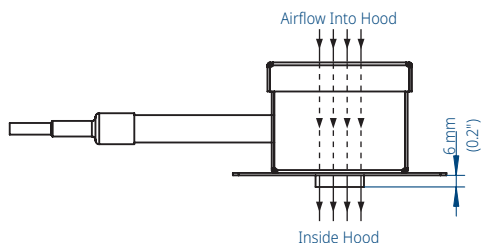

## Velocity Sensor

Velocity Range	0.2 - 0.9 m/s (39 - 177 fpm)
Required Input Voltage	12 VDC
Output Voltage Range	0.5 - 10 VDC
Power Consumption	0.6 W
Temperature Compensation Range	18°C - 30°C (64°F - 86°F)

## Sentinel XL User Interface Panel Technical Specifications (Mount on Fume Hood Side Post)

Front View

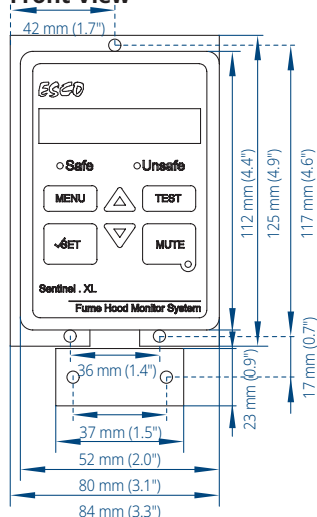

Mounting Position

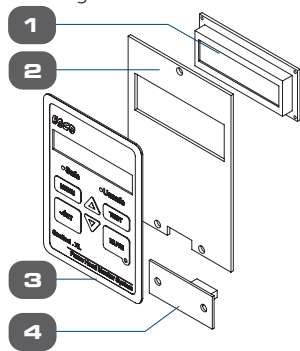

1. LCD
2. Mounting panel
3. Membrane switch keypad
4. Interface board

## Electrical Enclosure (Mounts at Top of Hood)

Front View

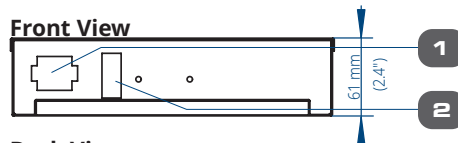

Back View

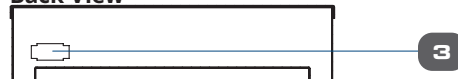

Top View

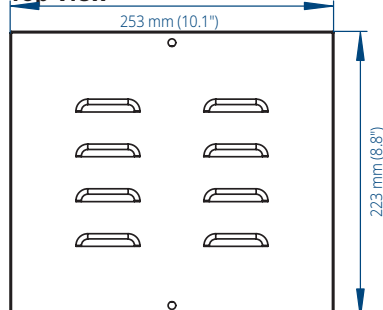

1. Cable to user interface panel
2. Cable to airflow sensor
3. Main AC inlet



**Esco Micro Pte. Ltd.**  
19 Changi South Street 1, Singapore 486 779  
Tel: +65 6542 0833 • mail@escolifesciences.com  
www.escolifesciences.com

**Esco Technologies, Inc.**  
903 Sheehy Drive, Suite F, Horsham, PA 19044, USA  
Tel: +1 215-441-9661  
eti.admin@escolifesciences.com



**Esco Lifesciences Offices:** Bangladesh | China | Denmark | Germany | Hong Kong | Indonesia | Italy | Lithuania | Malaysia | Myanmar | Philippines | Russia | Singapore | South Africa | South Korea | Taiwan | Thailand | UAE | UK | USA | Vietnam

